

Retail / Restaurant Space for Lease



7301-7575 EAST 29TH AVENUE | DENVER, COLORADO 80238

Sam Zaitz
+1 303 931 1201
sam.zaitz@jll.com

Lorenzo Harris
+1 720 431 9122
lorenzo.harris@jll.com

1225 17th Street
Suite #1900
Denver, CO 80202



Highlights



Premier high-traffic retail property



Affluent Central Park neighborhood



Unique mix of tenants



Strong demographics



1,000's of new homes under construction



2nd gen restaurant space available



Pedestrian friendly



Ample parking

Demographics

	1 MILE	3 MILES	5 MILES
Current Population	21,762	147,703	443,427
Total Households	8,705	57,708	191,795
Daytime Population	19,622	154,748	533,477
Avg Household Income	\$162,950	\$135,582	\$116,927



Retail Plan

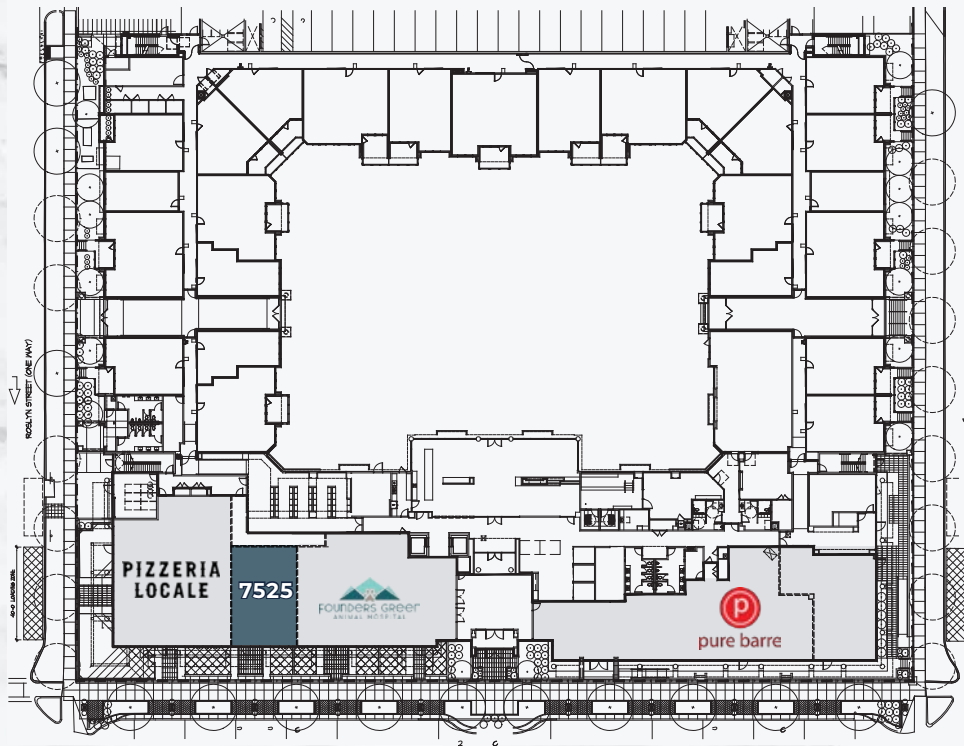
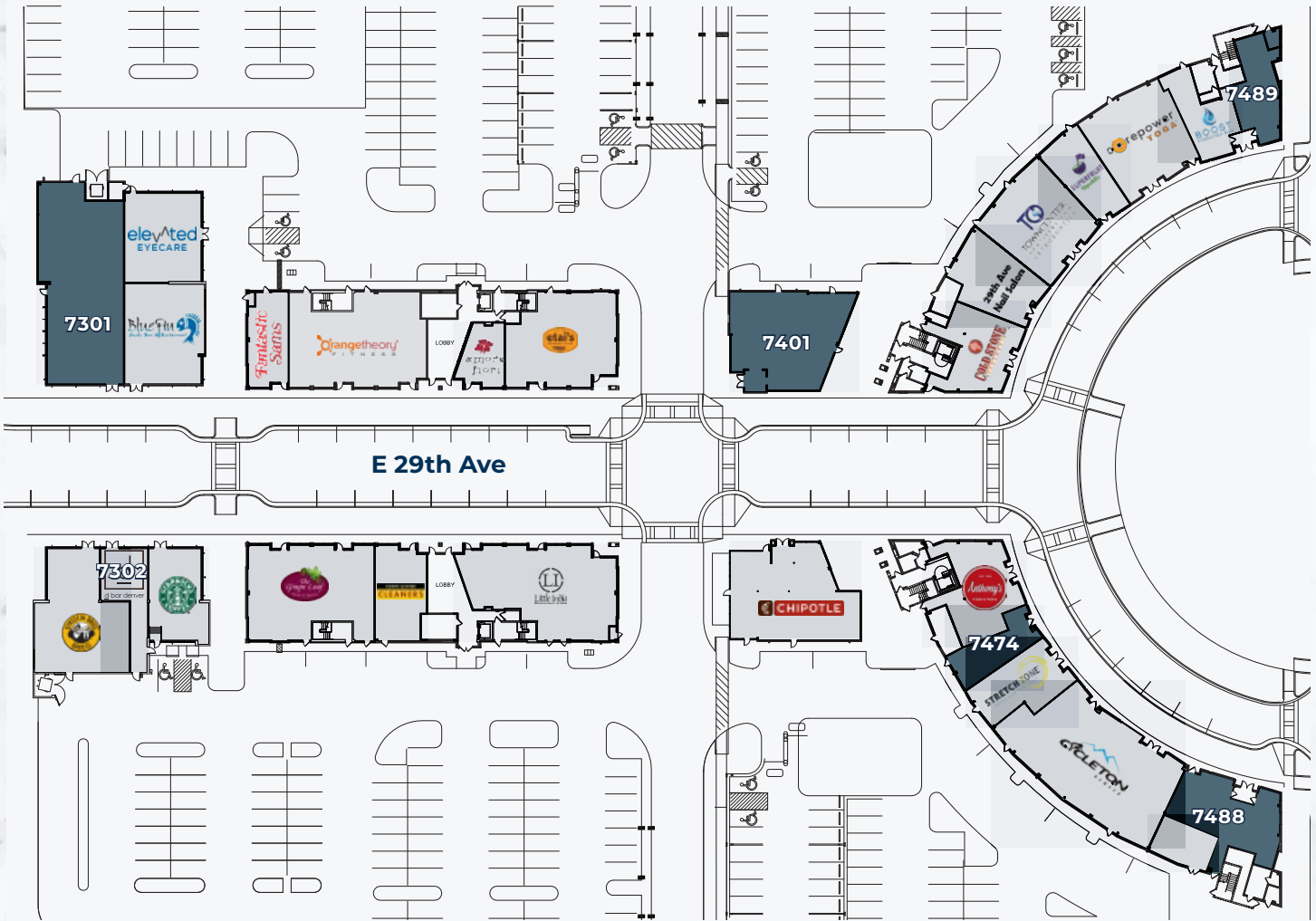

Availability

*7301	5,033 SF
*7401	3,300 SF
7474	966 SF
7488	2,011 SF
7489	1,173 SF
7525	1,200 SF

*2nd gen restaurant space

RETAIL & OFFICE FOR LEASE

The Mint



Retail Space Available:

- Unit 300: 1,799 SF
- Unit 400: 1,525 SF

Site Plan

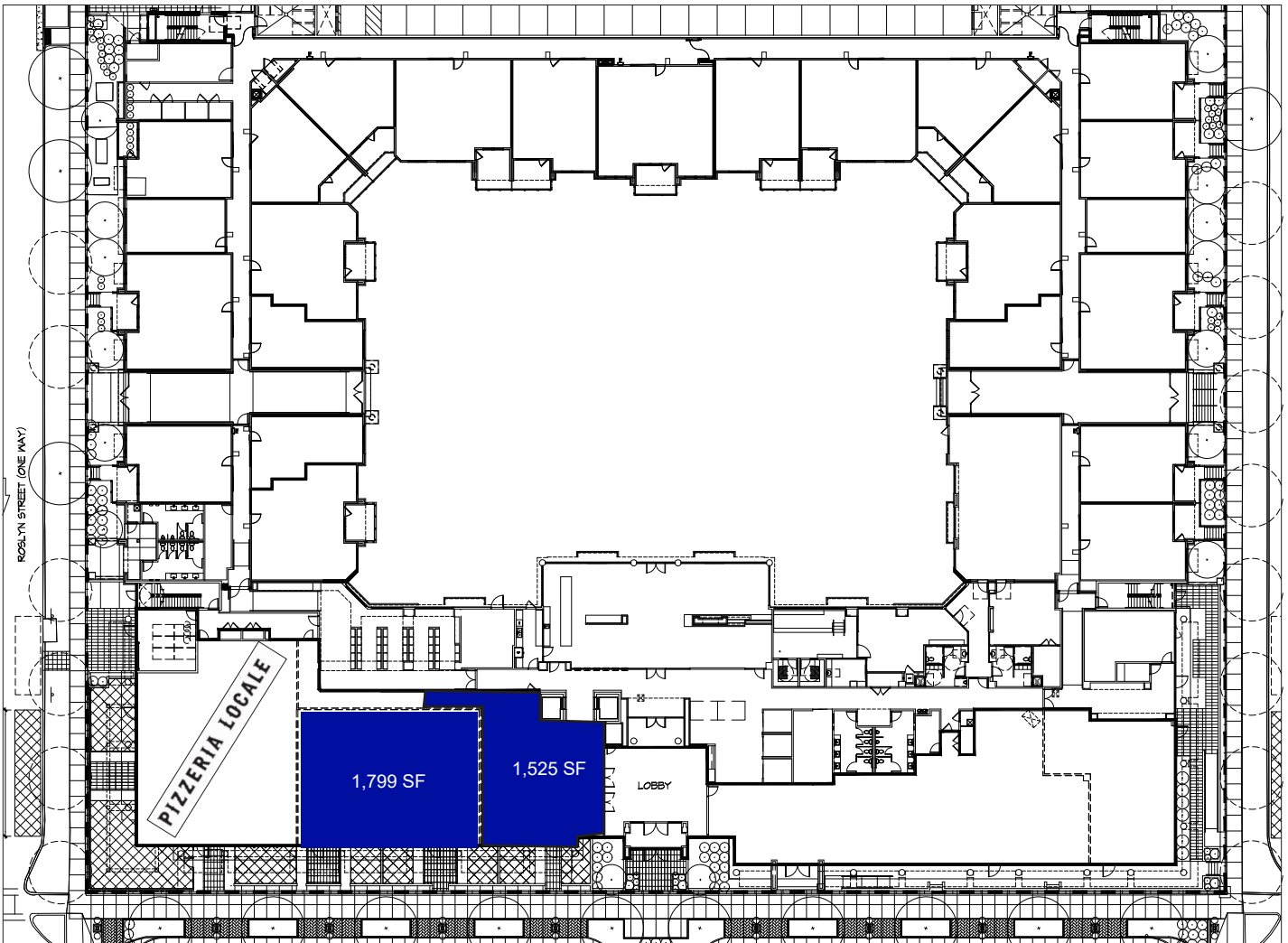

E 29TH PLACE

Neighborhood

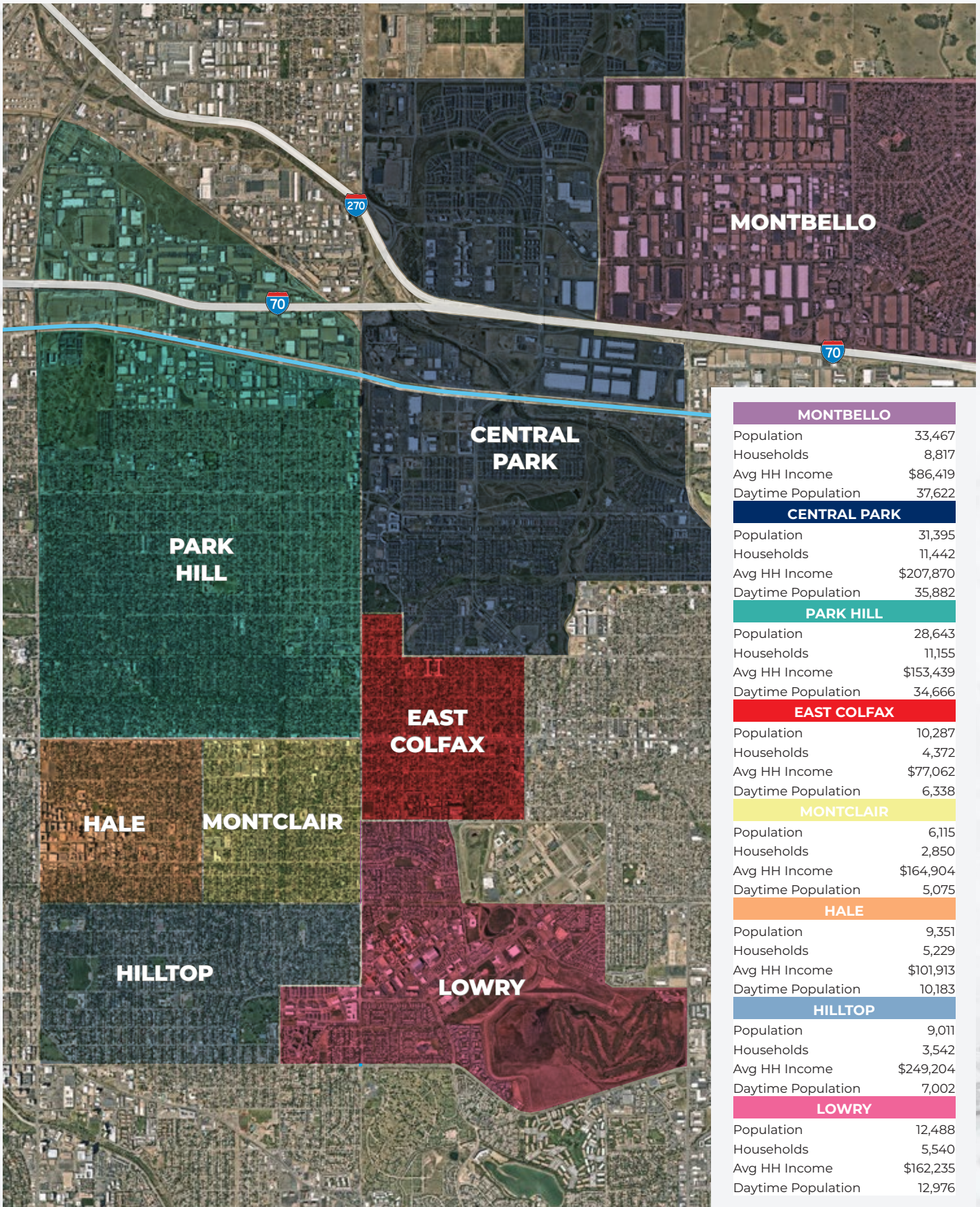

Retail Aerial





THE
TOWN CENTER
COLLECTION

Sam Zaitz
+1 303 931 1201
sam.zaitz@jll.com

Lorenzo Harris
+1 720 431 9122
lorenzo.harris@jll.com

1225 17th Street
Suite #1900
Denver, CO 80202

